



Before installation these instructions must be fully read and understood.

General

The 9100 Series ARC® Valve is an automatic, modulating, recirculation control valve for protection of centrifugal pumps and high speed pumps against overheating and possible unstable operation during low-load periods. With only three moving parts (disc, seal and spring), the valve functions simultaneously as: (1) check valve — to prevent flow through the pump and function as a flow sensor and (2) bypass control valve — to maintain the minimum pump flow and provide pressure letdown.

Features

1. Five separate functions in a single valve body without external power source: (a) reverse flow prevention, (b) low flow detection, (c) modulating bypass flow control, (d) bypass flow pressure reduction, and (e) back pressure regulation of bypass flow (as required).
2. Compact, self-contained design that eliminates divided installation responsibility occurring with systems involving combinations of pneumatic, thermal and mechanical devices.
3. Minimum wear on vital parts during pressure reduction of bypass flow.
4. Quiet pressure drop provided by a bypass that dissipates the energy effectively. For high pressure drop capability and/or increased cavitation resistance a back pressure regulator is available. External bypass regulators are available for mounting in down stream piping.
5. Corrosion resistant surfacing of disc seat.
6. Steel or stainless steel body available. Elastomer seals allow usage to 475°F [246°C]. Service exceeding these temperatures use the extreme temperature valve design. Refer to separate manual supplement for information.
7. Available with materials covered by N.A.C.E. Standard MR-01-75 (sulfide stress cracking resistant metallic material for oil field equipment).
8. All connections flanged.

Operation

Flow through the check valve overcomes the spring force to open the main check valve element. As the disc lifts in response to an increase in main flow, the connected bypass element reduces the bypass flow. Conversely, as the pump flow is reduced, the check valve assembly moves downward and at a point starts to uncover ports in the bypass element allowing bypass flow to begin. Further reduction in main flow increases the opening in the bypass element resulting in increased bypass flow. The sizing of the check valve disc and bypass element is such that the bypass flow starts before the main flow is reduced below the specified minimum pump flow, and the combined main and bypass flow provide a total greater than the pump minimum flow requirement.

Bypass flow enters the bypass element at the bottom of the bypass stem. The flow is then controlled by the port openings in the side of the bypass stem. The flow continues through the annulus in the bypass bushing and is directed to the outlet of the valve. For applications where a back pressure regulator is used, the regulator maintains an approximate back pressure from 50 psi [3.5 bar] to 500 psi [34.5 bar] above the receiver vessel pressure on the bypass element (as determined by Tyco). The back pressure regulator is available for mounting in downstream piping.

The controlled fit between the disc assembly, stem and bypass bushing permits a small amount of bypass flow with the check valve fully open.

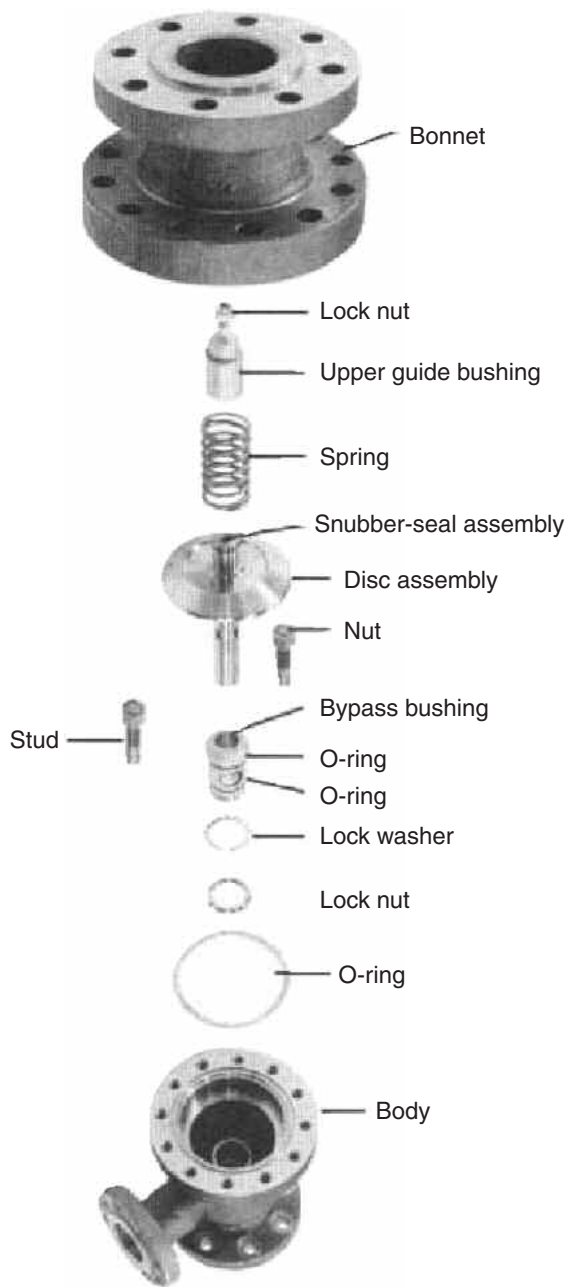

2" - 8" [50 - 200 mm] valves

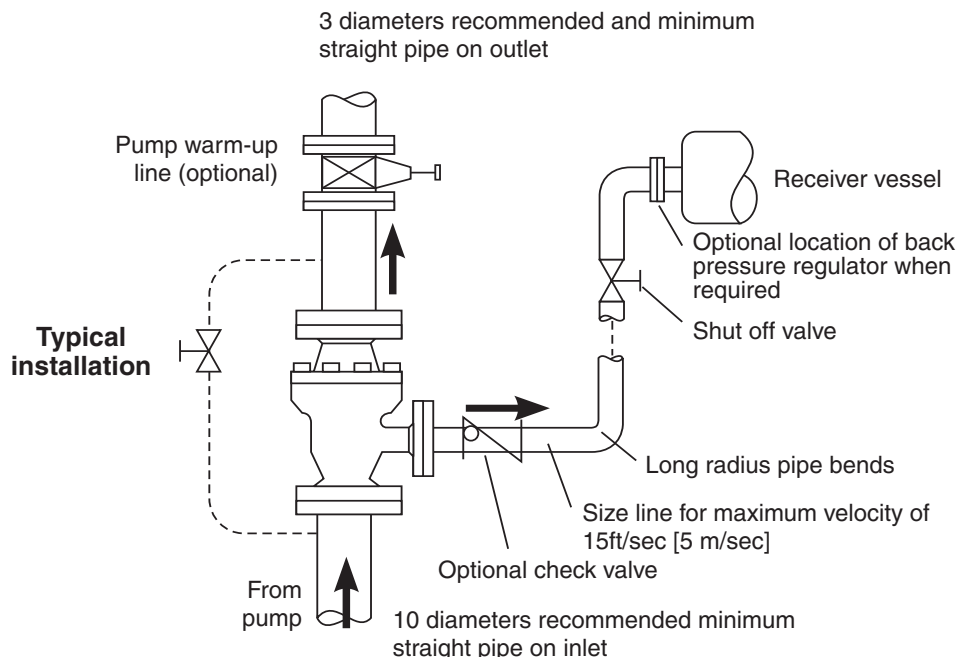

Installation

All elements of ARC® valve are chosen in accordance with the original installation specifications supplied by the user. Make certain these specifications are still applicable to the valve. Changes in pressure, temperature, main flow and required minimum flow can cause unsatisfactory operation. When specification changes are apparent, contact Yarway; modifications may be required prior to installation.

Remove all packing material. Place on wood support blocks with main flow arrow pointed downward. Push the disc from its seat and flush away any packaging debris with compressed air or high pressure water. The disc should move freely (against spring load) for the entire stroke. See Table 5 for stroke length.

Observe that the hole in the bypass bushing lines up with the bypass port. The valve may be installed with the main flow direction either horizontal or vertical upward. The direction of the bypass flow may be selected to suit the installation.

Operational Check

When the valve is properly installed the combined main and bypass flows should equal or exceed that of the specified minimum pump flow. If operational checks indicate a deviation from the original specifications and field adjustments are necessary, contact the Yarway Corporation for additional information.

Valve Care

Except for periodic operational checks the valve requires little maintenance. The disc assembly, spring and bypass bushing should be inspected coincident with the other annual inspections. The mechanism is easily removed whenever the main flow is stopped. Make certain that all pressure is relieved and the pipeline is secured against pressurization before attempting disassembly for inspection purposes.

Table 1 - Integral back pressure regulator draw bolt and washer

Valve Size		BPR Size		Bolt Thread	Bolt Length		Minimum Thread Length		Washer OD		Washer ID		Washer Thickness	
in.	[mm]	in.	[mm]	in.	in.	[mm]	in.	[mm]	in.	[mm]	in.	[mm]	in.	[mm]
2	[50]	1½	[40]	10 - 24	3½	[90]	1½	[38]	1½/16	[27]	7/32	[6]	1/16	[1.5]
3	[80]	2	[50]	¼ - 20	4	[102]	1½	[38]	1¾/8	[35]	9/32	[7]	1/16	[1.5]
4	[100]	3	[80]	¼ - 20	5½	[140]	1¾/4	[45]	2½/16	[52]	9/32	[7]	1/8	[3]
6	[150]	4	[100]	5/16 - 18	7	[178]	2¼/4	[57]	27/8	[73]	11/32	[9]	1/8	[3]
8	[200]	6	[150]	¾ - 16	8¾/4	[222]	3	[76]	4¾/4	[121]	13/32	[10]	1/8	[3]

Disassembly

2" - 8" [50 - 200 mm] valve sizes

1. For disassembly and inspection remove the valve from the line. Match-mark the body and bonnet to facilitate reassembly.
2. Remove the nuts attaching the valve bonnet to the body.
3. Carefully lift straight up on the bonnet to clear engagement of the disc stem.
4. The spring and disc assembly are now exposed for easy removal.
5. The main check flow element (29) (8" valve only) also, does not normally require maintenance. Should there be a need to remove the flow element, simply back out the (4) set screws (30). Next, using the same threaded holes, insert (2) lifting screws 180° apart. Take care to lift flow element evenly to prevent jamming within the body.
6. Normally there is no need to remove the bypass bushing. Should the bushing be damaged, it may be removed by opening the lock washer tab and using a hammer and rod or a bearing nut driver (see Table 3 for size). To remove locknut, drive the bushing out with a soft metal rod.
7. If the valve is fitted with an integral back pressure regulator and the unit needs to be replaced, carefully drill out the stake mark in the plunger guide with a small drill. Install draw bolt and washer (see Table 1 for sizes) and tighten until "snug." Torque = 5 to 10 ft./lb. [6.8 - 13.6 N•m]. Loosen the remaining ring (clockwise) approximately one turn and remove the spiral ring. Partially remove the draw bolt. Pry under the head of the draw bolt to remove the regulator capsule.

Caution

The back pressure regulator has an integral spring and if the draw bolt is removed, it should be done carefully. See separate instructions for external back pressure regulator.

8. If the valve is fitted with a flow conditioner (31), it can be removed by pencil grinding the tack welds and lifting the worn part from the body (1).

1" - 1½" [25 - 40 mm] valve sizes

1. Follow Disassembly, step 1 for 2" - 8" valves.
2. Remove the nuts attaching the valve bonnet to the body, remove the bonnet.
3. Remove the bypass tube as follows: Drill out the stake mark with a small drill. Use a spanner wrench in the tube slots and turn counterclockwise to remove. A 1" x 2" x 1/8" [25 x 50 x 3 mm] thick steel plate and an adjustable wrench may be used if a suitable spanner wrench is not available.
4. Remove the disc-bypass bushing assembly (Items 33, 34, 36, 37, 38, 39, 40, and 42) by applying force to the bottom of the disc as follows: Push on the bottom of the disc with a 1" [25 mm] diameter bar until the spring is fully compressed. Tap on the bar with a mallet if additional force is required.
5. Lay the disc-bypass bushing assembly on a flat surface with the bottom of the disc up. Push down on the spring retainer (36) until the spiral ring (38) is exposed. Remove the spiral ring by inserting a screwdriver into the ring removal notch and uncoiling the ring over the shaft end. The assembly can now be taken apart.

Repair and Inspection

Inspect the condition of the body to bonnet seal. Sealing surfaces must be free of defects. Replace the elastomer seal each time the valve is disassembled.

Examine the snubber-seal assembly for wear. The snubber should project slightly beyond guide diameter and with finger pressure should compress and expand.

Examine the check valve seat for evidence of wear. The surface can be reconditioned by lapping (see Reassembly, step 6).

Supply the following information when ordering spare parts:

- (1) Figure Number
- (2) Serial Number
- (3) Type of fluid

Reassembly - All Classes

2" - 8" [50 - 200 mm] valve sizes

1. All parts must be clean prior to reassembly.
2. Torque the upper guide bushing nut to the following values (Table 2) Do not lubricate.

Table 2 - Upper Guide Bushing

Valve Size		Nut Size in.	Torque	
in.	[mm]		ft/lb	[N•m]
2	[50]	7/16 - 20	30 - 35	[41 - 48]
3	[80]	1/2 - 13	45 - 50	[61 - 68]
4	[100]	5/8 - 11	90 - 110	[122 - 149]
6	[150]	3/4 - 10	160 - 200	[217 - 271]
8	[200]	1 - 8	305 - 355	[414 - 481]

3. Install new O-rings on the bypass bushing (use O-ring lube).
4. The hole in the bypass bushing must line up with the bypass port. Use a soft metal rod to maintain the hole location when torquing the bearing nut.
5. Torque the bearing nut to the bypassing bushing using the torque values listed in Table 3 (use anti-seize on threads). Bend the lockwasher tab in the slot of the locknut.

Lubricants

Use the following lubricants or their equivalents:

Anti-seize — Never-Seez NS 165 (pure nickel special).

O-ring — Silicone lubricant or liquid soap.

Table 3 - Bypass Bushing Nut

Valve Size		Nut Size in.	Torque	
in.	[mm]		ft/lb	[N•m]
2	[50]	1 1/8 - 18 N-06	40 - 60	[54 - 81]
3	[80]	1 3/4 - 18 N-09	150 - 190	[203 - 258]
4	[100]	2 3/8 - 18 N-12	250 - 300	[339 - 407]
6	[150]	2 3/4 - 18 N-14	300 - 350	[407 - 474]
8	[200]	4 3/8 - 12 AN-22	480 - 550	[651 - 746]

6. Lap the disc to the body. First use 180 grit (medium coarse) and repeat with 360 grit (fine). The finished surface should be 360 degrees and a minimum of 1/2 the available seat width. Clean thoroughly after each lapping operation.
7. Install the snubber seal assembly in the groove on the stem/disc assembly using O-ring lube. (O-ring first, followed by Glyd ring.) Heat Glyd ring 140 - 212F [60 - 100C] water prior to installation. Resize ring with hose clamp and shim stock after seal is in groove. Allow to cool 10-20 minutes to resize.
8. To reinstall flow element (29), reverse the procedure described in Disassembly, step 5. Retorque the four 3/8"-UNC set screws (30) 20 - 25 ft-lbs [27-34 N•m].
9. Install the stem/disc assembly into the valve body. Place the spring on the stem/disc. Lower the bonnet, with match-marks aligned, into place using care not to damage the snubber seal.
10. Coat studs with anti-seize lubricant prior to assembly. Torque to the values in Table 4.

Table 4 - Body Bonnet Nuts

Valve Size		Nut Size	Torque	
in.	[mm]	in.	ft/lb	[N•m]
1 - 1 1/2	[25 - 40]	9/16 - 12	65 - 70	[88 - 95]
2	[50]	5/8 - 11	70 - 80	[95 - 109]
3	[80]	3/4 - 10	120 - 140	[163 - 190]
4	[100]	7/8 - 9	180 - 220	[244 - 298]
6	[150]	1 1/8 - 8	450 - 500	[610 - 678]
8	[200]	1 1/4 - 8	600 - 660	[814 - 895]

11. Check valve stroke by pushing the bottom of the bypass stem with wood or soft metal rod. The disc assembly must move freely (against spring load) for the entire stroke length. The stroke length must be as follows:

Table 5 - Disc Stroke

Valve Size		Stroke Length	
in.	[mm]	in.	[mm]
1 - 1 1/2	[25 - 40]	7/16	[11]
2	[50]	5/8	[16]
3	[80]	1 5/16	[24]
4	[100]	1 1/4	[32]
6	[150]	1 1/2	[38]
8	[200]	2	[50]

12. For valves with an integral back pressure regulator:
 - a. Install new regulator capsule, if defective. Lube the O-ring with O-ring lubricant and install the back pressure regulator capsule into the body.
 - b. Install the spiral ring into the body groove (lubricate bottom side with Anti-Seize).
 - c. Coat exposed threads with a thread locking adhesive appropriate for the valve service temperatures. Back the retaining ring out to load the back pressure regulator capsule with the required torque as shown in Table 6. Remove and discard the draw bolt and washer (used to hold the capsule assembly together.) Stake the plunger guide into the retaining ring. Do not stake toward the centerline of the back pressure regulator.

Table 6 - BPR Retaining Ring (spanner nut)

Regulator Size		Nut Size	Torque	
in.	[mm]	in.	ft/lb	[N•m]
1 1/2	[40]	1 1/8 - 12	20 - 25	[27 - 34]
2	[50]	1 7/16 - 12	45 - 55	[61 - 75]
3	[80]	2 1/8 - 12	100 - 120	[136 - 163]
4	[100]	2 7/8 - 12	180 - 220	[244 - 298]
6	[150]	4 3/4 - 12	300 - 340	[406 - 460]

- For valves with a flow conditioner (31), a replacement can be installed and tack welded in place using ER-309 weld wire. Weld four places, 90 degrees apart. See Table 7 for weld size and width.

Table 7

Valve Size		Weld Size		Weld Width	
in.	[mm]	in.	[mm]	in.	[mm]
2	[50]	1/8	[3]	3/16	[5]
3	[80]	1/8	[3]	1/4	[6]
4	[100]	1/8	[3]	3/8	[10]
6	[150]	1/4	[6]	1/2	[13]
8	[200]	1/4	[6]	5/8	[16]

1” - 1½” [25 - 40 mm] valve sizes

- All parts must be clean prior to reassembly.
- Insert the bypass bushing without the O-ring in the valve body to guide the disc during the lapping. Lap the disc to the body per step 6 above.
- Install the snubber seal assembly (42) in the groove on the disc (33) per step 7 above.
- Assemble the disc-bypass bushing parts (Items 33, 34, 36, 37, 38, 39, 40, and 42) as follows. Assemble all parts except the spiral ring (38) and lay the assembly on a flat surface with the bottom of the disc up. Compress the spring by pushing down on the spring retainer until the groove in the bottom of the disc is exposed. Install the spiral ring (38) by separating the coils and inserting one end of ring into groove and spiral each turn progressively over the shaft. Slowly release the load on the retainer.
- To prepare the disc-bypass bushing assembly for installation in the valve body, the spring (37) must be compressed and restrained. There are two spring restraining methods, one uses a tool and the other a dowel pin. Using the disc-bypass bushing assembly illustrations as a guide, visually compare the parts to the illustrations and determine if the provisions are for the old or new method. The old method has a hole in both the disc and bypass bushing to accept a tool. The new method has only a hole in the disc for a dowel pin. Both types of spring restrainers will be held in place by the spring load. Prepare the disc-bypass bushing assembly for installation in the valve body as described by 5a or 5b below as applicable.
 - For the old restraining method, a tool must be fashioned by bending a metal rod as shown. Compress and rotate the disc and bypass bushing together to align the assembly holes. Insert the spring restrainer tool in the assembly holes and release the spring load.
 - For the new restraining method, provide the dowel pin as shown. Compress the disc and bypass bushing together until the pin assembly hole is exposed. Insert the spring restrainer pin in the assembly hole and release the spring load.
- Visually align the centerline of the threaded outlet hole in the bypass bushing (34) with the body bypass outlet hole centerline. Insert the disc-bypass bushing in the body carefully so as not to knock the spring restrainer loose.
- Rotate and push or pull on the disc to accurately align the bypass outlet holes. Shine a light in the bottom of the disc hole while looking through the body bypass outlet to check alignment.
- Install the bypass tube (35) into the body outlet, threaded end first. Thread the tube into the bypass bushing (34) and tighten to approximately 20 ft/lbs [27 N•m] torque using a spanner wrench or a 1” x 2” x 1/8” [25 x 50 x 3 mm] thick steel plate. Stake the body into the bypass tube slots.
- Remove spring restrainer, tool or dowel as applicable, by pushing on the bottom of the disc to release the spring load. The tool should become loose for removal. The pin should fall out. Ensure restrainer pin either falls out or is removed from the valve body before placing the valve back in service.
- Lubricate, assemble, and check valve stroke per steps 9 and 10 under the 2” - 8” instructions.

Bypass with back pressure regulator installed **

2" - 8" [50 - 200 mm] valves

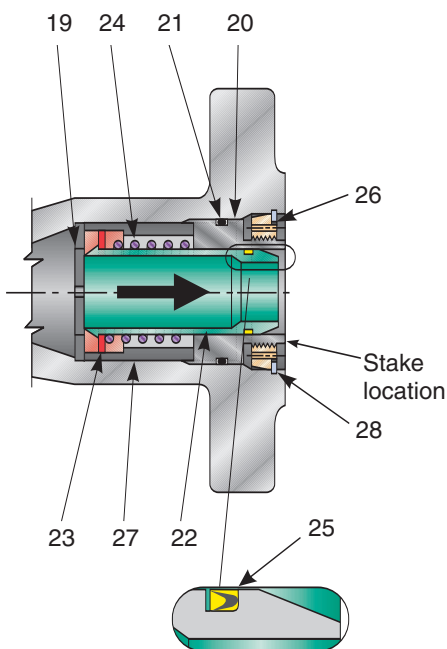
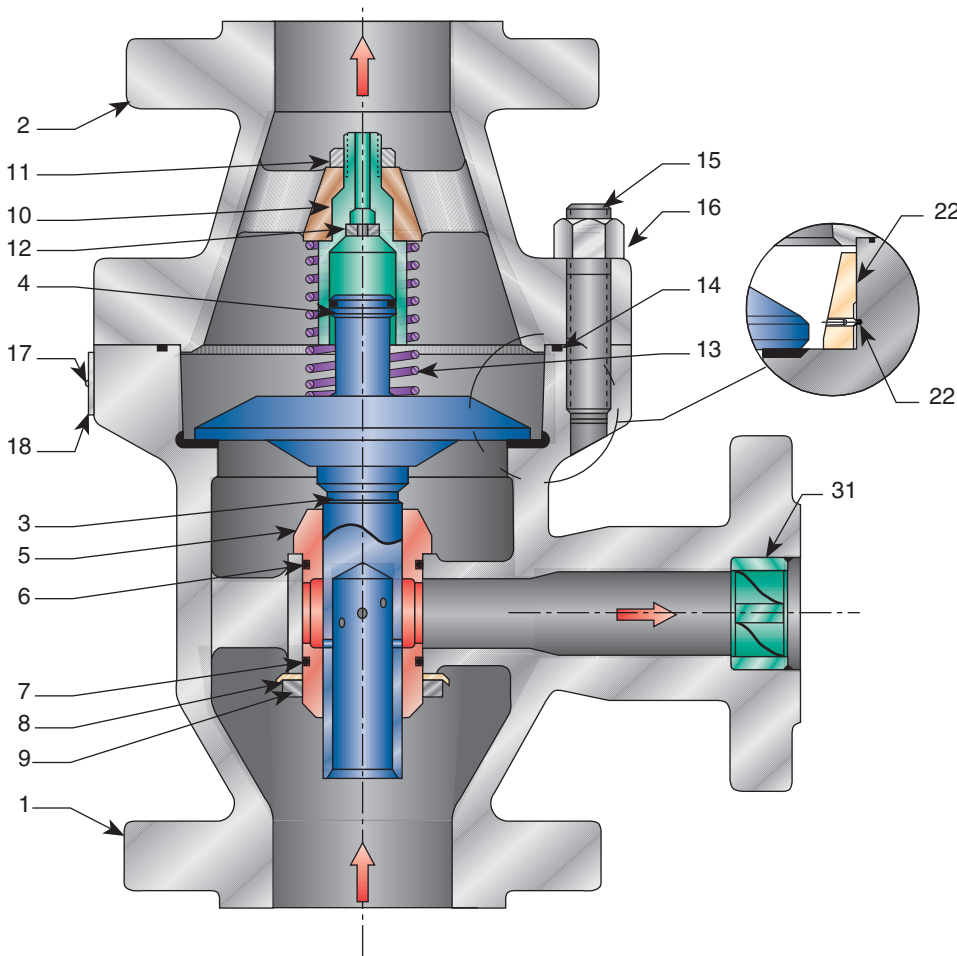

Parts List

Item	Part
1	Body
2	Bonnet
3†	Disc Assembly
4†	Snubber Seal Assembly
5†	Bypass Bushing
6†	O-ring
7†	O-ring
8†	Lock Washer
9†	Lock Nut
10†	Upper Guide Bushing
11†	Lock Nut
12†	Snubber Orifice
13†	Spring
14†	O-ring
15	Stud
16	Nut
17	Drive Screw
18	Nameplate
19**	Seat
20**	Plunger Guide
21**	O-ring
22**	Plunger
23**	Spring Retainer
24**	Spring
25**	Seal
26**	Retaining Ring
27**	Spacer
28**	Spiral Ring
29	Flow Element (8" only)
30	Set Screw (8" only)
31	Flow Conditioner

† Recommended spare parts (valve)

* Disc Assembly furnished with item 4.

Bypass Bushing furnished with items 6, 7, 8, and 9.

Upper guide bushing furnished with items 11, and 12.

** Back Pressure Regulator spare parts available only as a replacement capsule (parts 19 - 28).

Yarway High Pressure 9100 Series ARC® Valves 1 - 8 inch

Installation and Maintenance Instructions

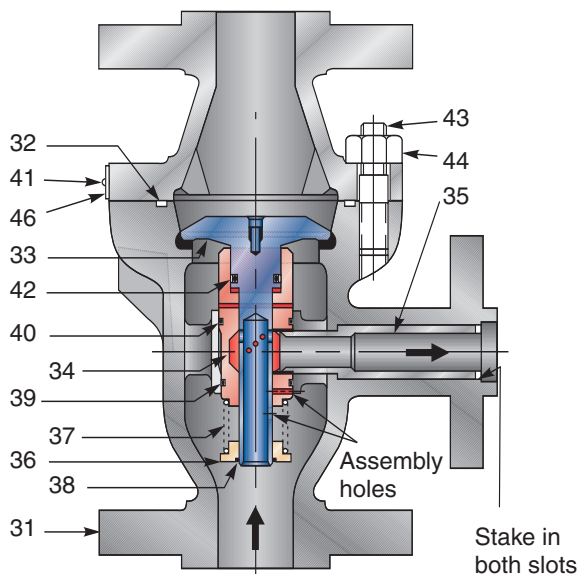

Parts List

Item	Part
31	Body
32	Bonnet
33†*	Disc
34†*	Bypass Bushing
35†	Bypass Tube
36*	Spring Retainer
37†*	Spring
38†*	Spiral Ring
39†*	O-ring
40†*	O-ring
41†	O-ring
42†*	Snubber-Seal Assembly
43	Stud
44	Nut
45	Drive Screw
46	Nameplate

† Recommended spare parts

* Disc furnished with item 42

Bypass Bushing furnished with Items 36, 37, 38, 39, 40.

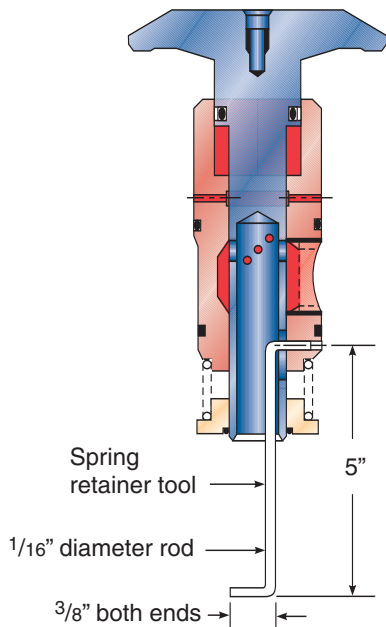

Disc-bypass bushing assembly

1" - 1 1/2" [25 - 40 mm] valves

Old restraining method

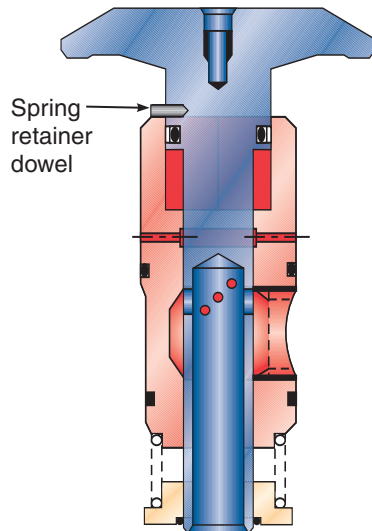

New restraining method

Stafford Facility Phone: 281-274-4400

Tyco Valves & Controls

www.tycovalves.com

Tyco Flow Control (TFC) provides the information herein in good faith but makes no representation as to its comprehensiveness or accuracy. This IOM is intended only as a guide to TFC products and services. Individuals using this data sheet must exercise their independent judgment in evaluating product selection and determining product appropriateness for their particular purpose and system requirements. TFC MAKES NO REPRESENTATIONS OR WARRANTIES, EITHER EXPRESS OR IMPLIED, INCLUDING WITHOUT LIMITATION ANY WARRANTIES OF MERCHANTABILITY OR FITNESS FOR A PARTICULAR PURPOSE WITH RESPECT TO THE INFORMATION SET FORTH HEREIN OR THE PRODUCT(S) TO WHICH THE INFORMATION REFERS. ACCORDINGLY, TFC WILL NOT BE RESPONSIBLE FOR DAMAGES (OF ANY KIND OR NATURE, INCLUDING INCIDENTAL, INDIRECT, OR CONSEQUENTIAL DAMAGES) RESULTING FROM THE USE OF OR RELIANCE UPON THIS INFORMATION. Patents and Patents Pending in the U.S. and foreign countries. Tyco reserves the right to change product designs and specifications without notice.

Engineering Doc. #965849 Rev. H